

Independent Living. Tower Floor Plans.



**MOUNT
ANGEL
TOWERS**

Our Tower apartments offer a beautiful town or mountain view. Some of our floor plans are shown below. Extra storage is available for those who want it.

Tower 1 Bedroom 550 sf

PRICE RANGE:

\$2675 - \$2925 per month

Price ranges quoted are as of the date the user visited the website and are subject to change at any time.

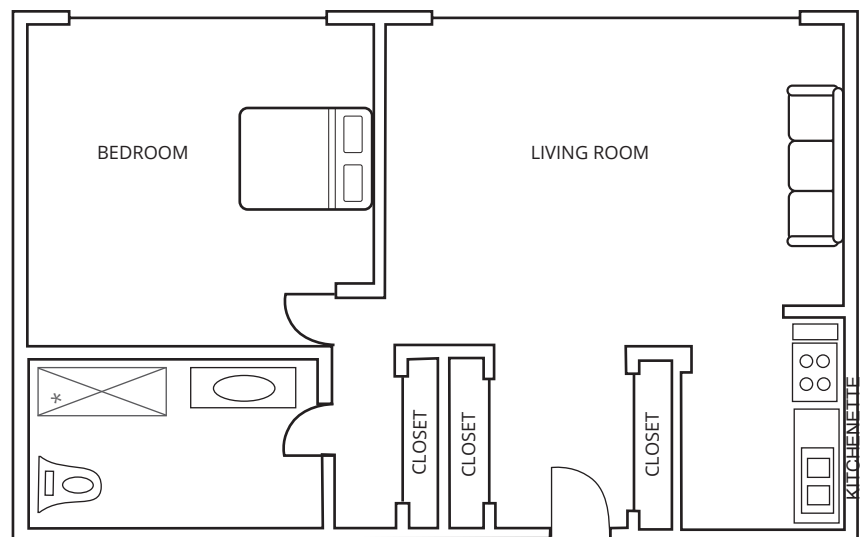

TOWER APARTMENTS INCLUDE:

- Spacious closets
- Heat & air conditioning controlled within each unit
- Bathrooms equipped for accessibility and safety
- All utilities and cable tv (not phone or internet)
- Fully equipped kitchens
- Abundant windows
- Easy access to 6th floor terrace
- Emergency call system
- Two meals per day

CALL TO BOOK A TOUR:

503-845-7211

www.MountAngelTowers.com